

OPM045 Splice Plate

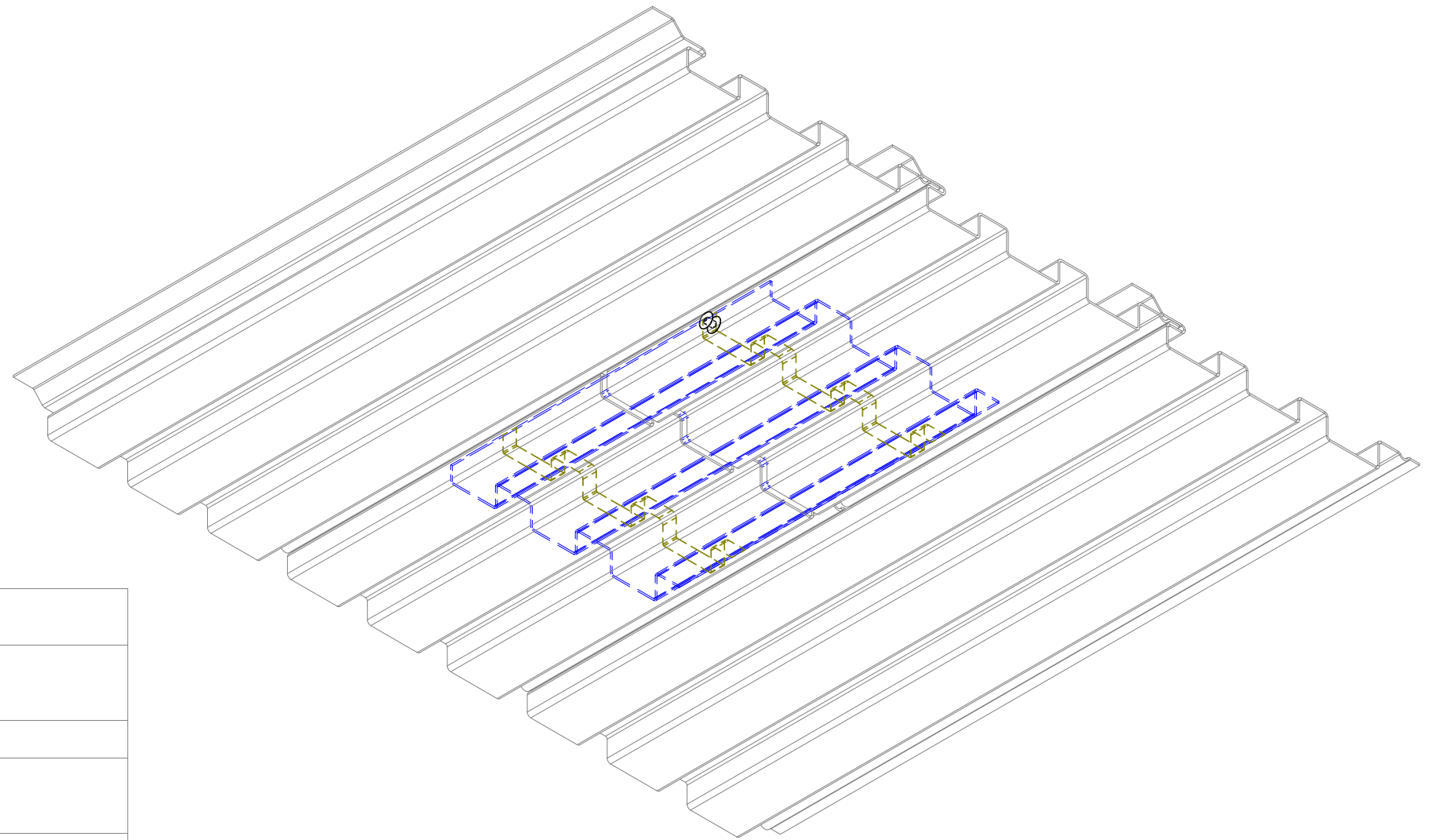

Non-Hardening Butyl Sealant Bead

Appropriate Gap
(1/8" - 1/4" Gap)

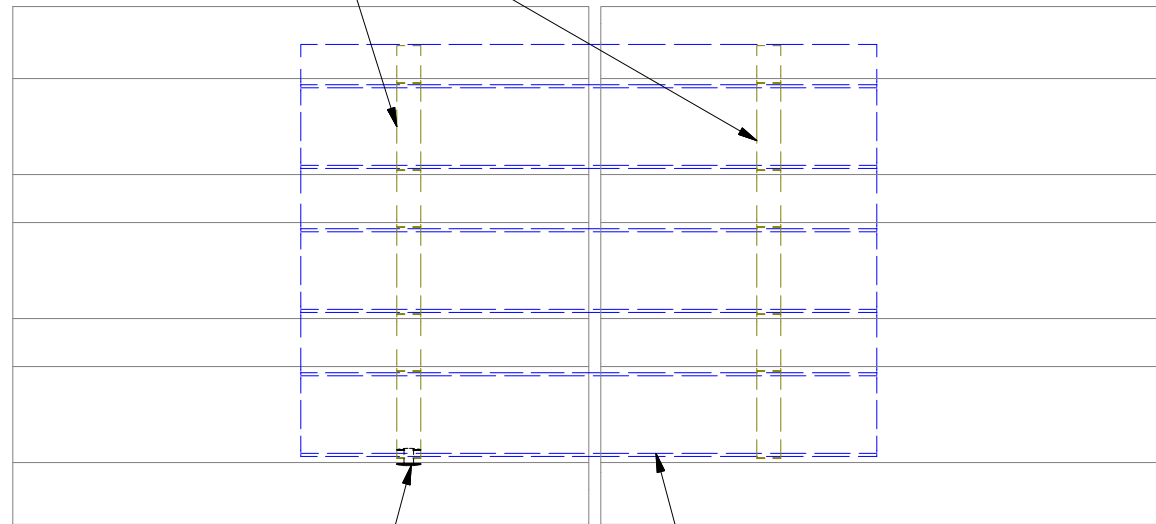

S.S. Painted Pop Rivet
(install one side only to allow
for expansion and contraction of panels)

Splice Plate

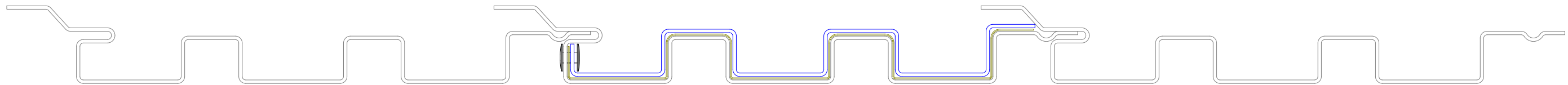

Note: * denotes color side.

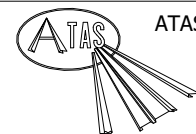

ATAS INTERNATIONAL, INC
Allentown PA
610-395-8445
Mesa AZ
480-558-7210

TITLE OPM045 Splice Detail

REV. NO.	DATE	DESCRIPTION OF REVISION	BY	APP	DWG. NO.	DR	KRK	DATE	8/20/2024
						APP		DATE	
					MATERIAL	SH. SIZE	B	SCALE	X:X