

After Wrapping Z Box Base around Penetration, Pop Rivet Base using Factory Pre-Punched Holes.

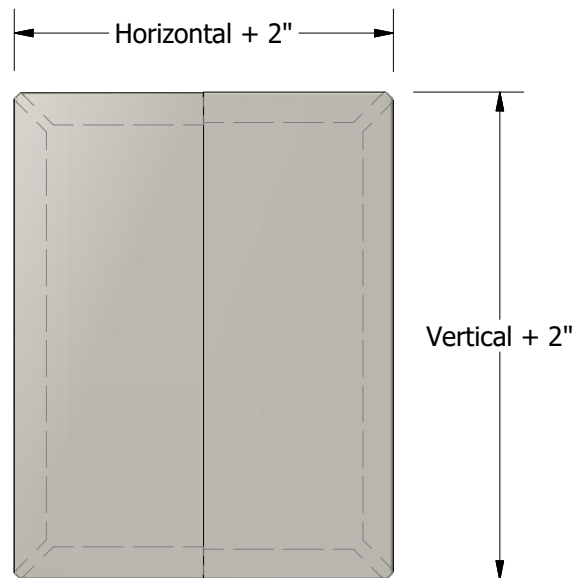

If a pre-punched shape is needed on cover specify it's dimensions and location.

NOTE: Retrofit covers are beneficial when a standard one piece cover cannot be slid over the feature being flashed. The cover seam can either be oriented vertically (as shown) or horizontally.

Order #

Base Dimensions

Horizontal:

Vertical:

For use with (Panel SKU):

or
Height (If specific size requested):

Alum: .032 ☐ .040 ☐

Steel: 24ga ☐

Color:

Quantity:

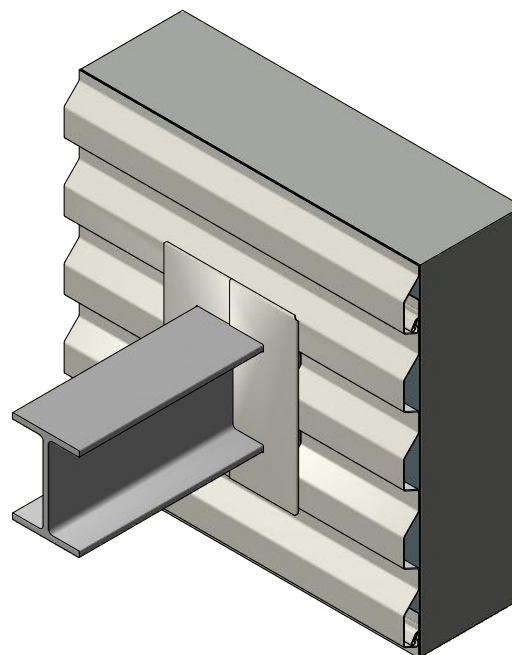
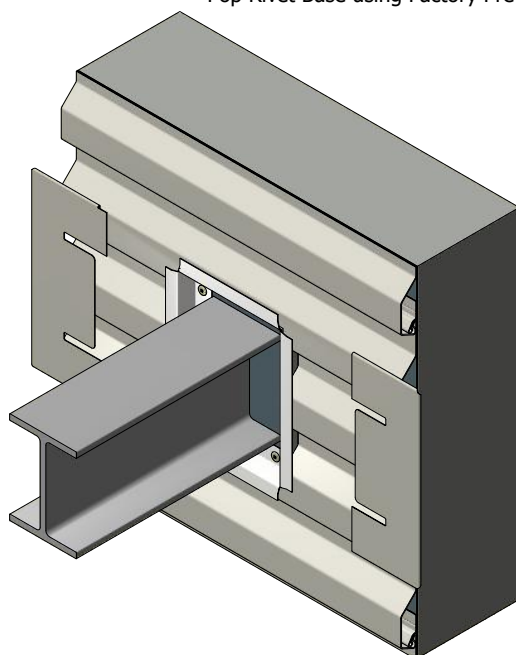

Patent Number: 10,439,380B2

03	2/1/2023	Added Note about Pop Rivet	KRK		TITLE	Z Box - Order Sheet - Retrofit Cover		
02	6/29/2022	Added Patent Number	KRK		DWG. NO.	DR	PJR	DATE 04-25-16
01	8/23/2021	Updated Materials	KRK	JPB	MATERIAL	APP		DATE
REV. NO.	DATE	DESCRIPTION OF REVISION	BY	APP		SH. SIZE	A	SCALE X:X

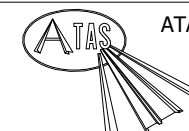

ATAS INTERNATIONAL, INC
Allentown PA
610-395-8445
Mesa AZ
480-558-7210